



REPORTAGE.
HEIGHTS

Live the Next

The logo for Reportage, featuring the word "Reportage" in a bold, black, sans-serif font. The letter "R" is stylized with a curved top. A small yellow dot is positioned at the end of the word, after the period.

Own your story

At Reportage Group, we're proud to be one of the largest private real estate developers in the United Arab Emirates, with projects spanning the UAE, Egypt, Turkey, Saudi Arabia, Uganda, Azerbaijan, Pakistan, and more international markets on the way.

Our focus is clear and consistent: to deliver innovative, sustainable, and accessible modern housing solutions that provide outstanding value for investors and a safe, welcoming home for everyone.

Our mission is to be among the most trusted real estate companies in the world, developing homes that are both modern and attainable, while fostering a true sense of belonging. We're excited for what the future holds and remain committed to expanding our footprint across the globe.



Sabah Investment Group (SIG) is a diversified international holding focused on real estate and private capital investments. Through a fully integrated structure covering every stage from acquisition to asset monetization, SIG ensures quality, efficiency, and long-term value.

Active across Azerbaijan, the UAE, Georgia, Turkey, and beyond, SIG drives visionary investment, responsible growth, and lasting value creation.

A STRATEGIC PARTNERSHIP SHAPING BAKU'S FUTURE

This project, located in Sea Breeze, Baku, Azerbaijan, represents a powerful collaboration between Reportage Group and SIG — two industry leaders joining forces in one of the most promising destinations in the region.

WELCOME TO BAKU



Situated on the vibrant shores of the **Caspian Sea**, **Baku** is a city where tradition meets innovation.

Known for its rich history, stunning architecture, and dynamic culture, Baku stands as **the heart of Azerbaijan** and one of the most exciting destinations in the Caucasus region.

The city blends Eastern charm with Western sophistication, creating a place where people come to live, work, and explore.



ABOUT SEA BREEZE

Sea Breeze stands as Baku's most prestigious coastal community, combining luxury, lifestyle, and investment potential.

Through this partnership, both companies aim to elevate the area's real estate landscape with a project that blends architectural elegance, modern living, and long-term value.



We build for those who see beyond today.
For visionaries who know the future isn't given it's created
Rising from Baku's Halfmoon, on a shoreline destined for the world,
Reportage Heights is not just a building, it is your signature.

It's foresight carved in stone.
Every line breathes intent.
Every view holds promise.
Every detail whispers possibility.

Here, every space unlocks opportunity,
Every sea view is a vow that grows richer with time.

This is a place for those who move first,
Who choose before others dare,
Who claim tomorrow, today.

Reportage Heights — Live the Next



DESIGN PHILOSOPHY

At Reportage Heights, architecture becomes ambition a dialogue between the sea and the skyline.

Crafted for those who don't just reside, but redefine the way they live and invest.

Each curve, reflection, and material choice is shaped with precision, offering panoramic views that merge serenity with success.

It's not just a development it's a declaration.

LOCATION HIGHLIGHTS

At the heart of Baku's rising skyline, Reportage Heights offers both exclusivity and connectivity a waterfront address that merges luxury with legacy.

- Halfmoon – within walking distance
- Landau School – within walking distance
- Dream Arena – within walking distance
- Sea Breeze Casino – within walking distance
- Heydar Aliyev International Airport – easy access





REDEFINING
COASTAL LIVING

RISE ABOVE
THE HORIZON



PROJECT DETAILS

Number of Floors	Ground Floor (mixed use) + 27 residential floors + 2 MEP floors
Number of Apartments:	1885 units
Minimum Apartment Area	29.6 sqm - Gross Area
Maximum Apartment Area	227.9 sqm - Gross Area
Ceiling Height	Typical floor - 3.6m (structural slab to slab distance)
Number of Pools:	2 Outdoor pools

SHAPED BY VISION,
BUILT WITH PRECISION





AMENITIES & SERVICES

- Underground parking
- 2 large outdoor swimming pools
- 4 high-speed elevators
- Gymnasium
- Landscaped green areas
- Fitness center
- Lounge area

Spaces crafted to complement ambition where leisure meets lifestyle, and comfort meets design excellence.





UNIT FEATURES

- Private balconies and terraces
- Kitchen cabinets and worktops
- Fully tiled bathrooms and guest restrooms
- Master bedroom
- Double-glazed windows
- Built-in wardrobes in bedrooms
- Shower cabins in every bathroom
- Centralized air conditioning system

Designed for balance and beauty every home is a seamless blend of modern luxury, functionality, and timeless detail.

DESIGNED
TO INSPIRE



UNIT MIX

Reportage Tower (1)

Studios: 523

One Bedroom: 145

Two Bedrooms: 14

Three Bedrooms: 1

Reportage Tower (2)

Studios: 414

One Bedroom: 172

Two Bedrooms: 14

Three Bedrooms: 1

Reportage Tower (3)

Studios: 414

One Bedroom: 172

Two Bedrooms: 14

Three Bedrooms: 1

Total Units: 1,885

A VIEW THAT
DEFINES SUCCESS





MODERN. MINIMAL
MEANINGFUL.

CRAFTED FOR
VISIONARIES

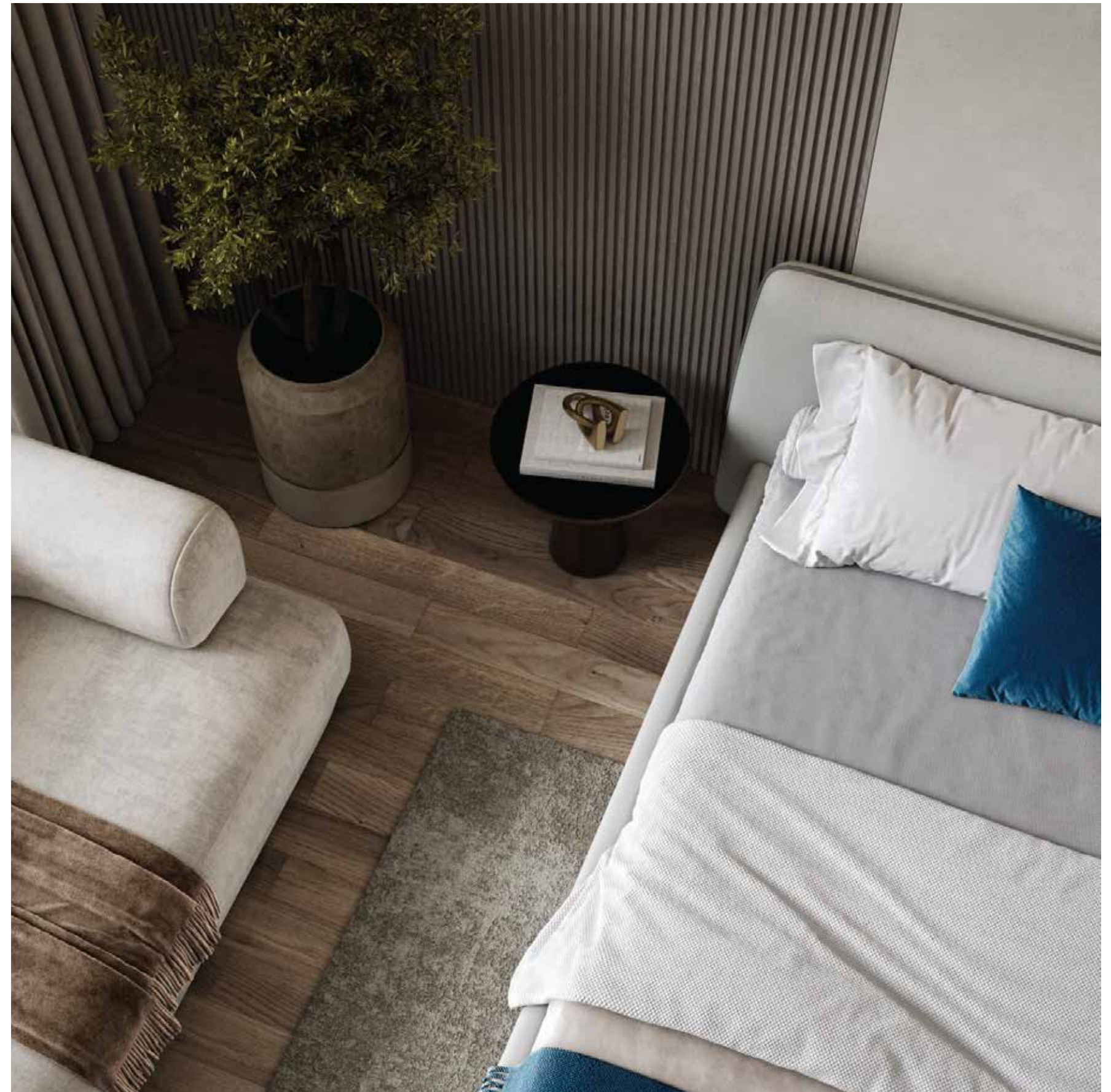



UNIT TYPE

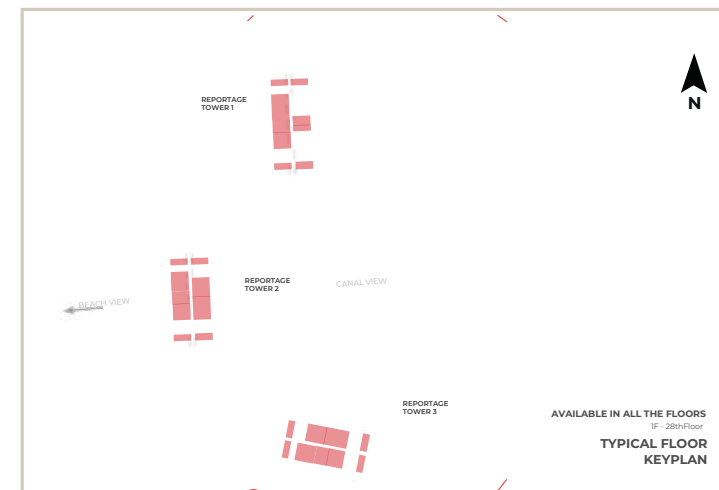
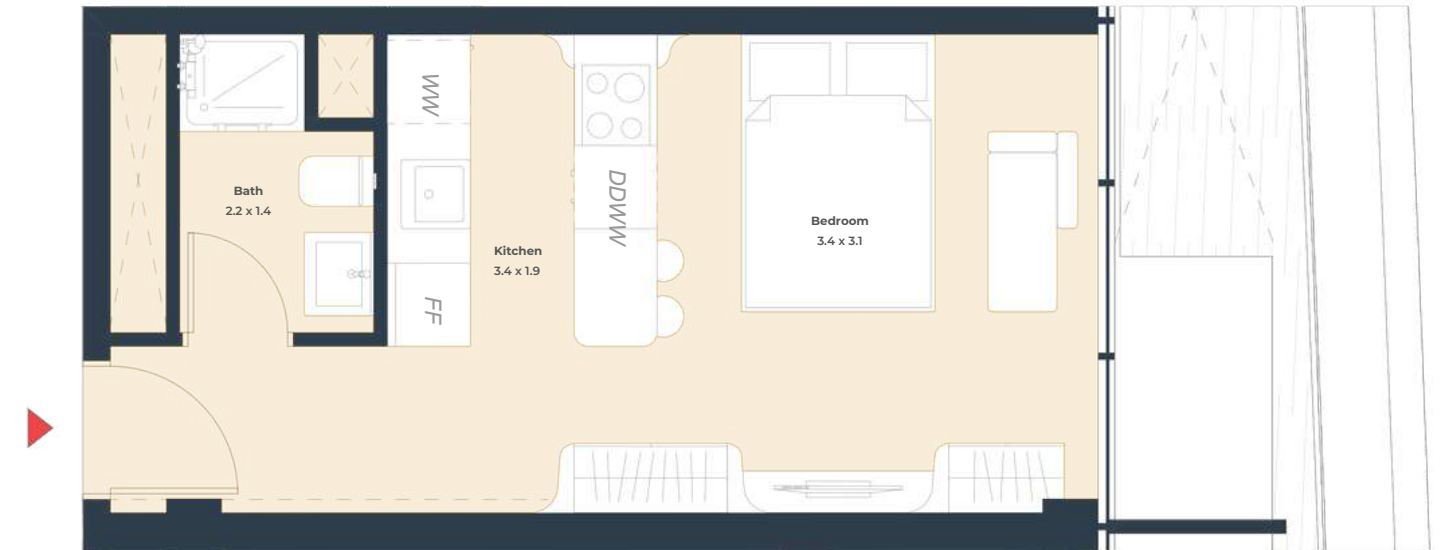

STUDIO A1

1F - 28th floor (Typical Floor)

Total Area	VARIES (29.37 sq.m - 43.47 sq.m)
Internal Area	VARIES (29.97 sq.m - 27.23 sq.m)
B alcony	VARIES (2.40 sq.m - 16.25 sq.m)

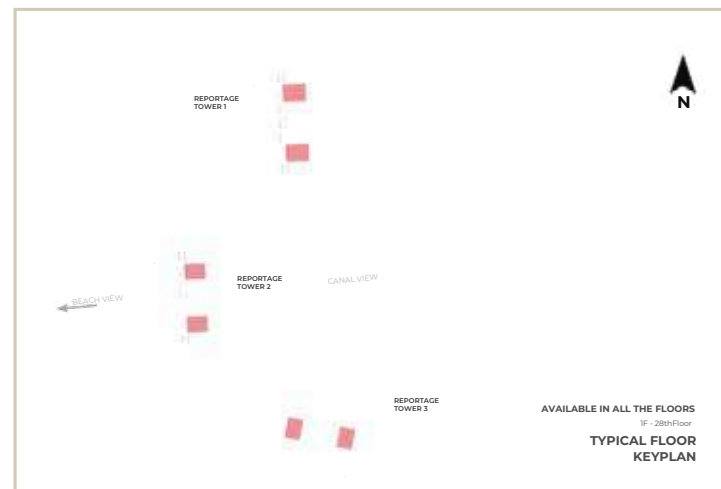
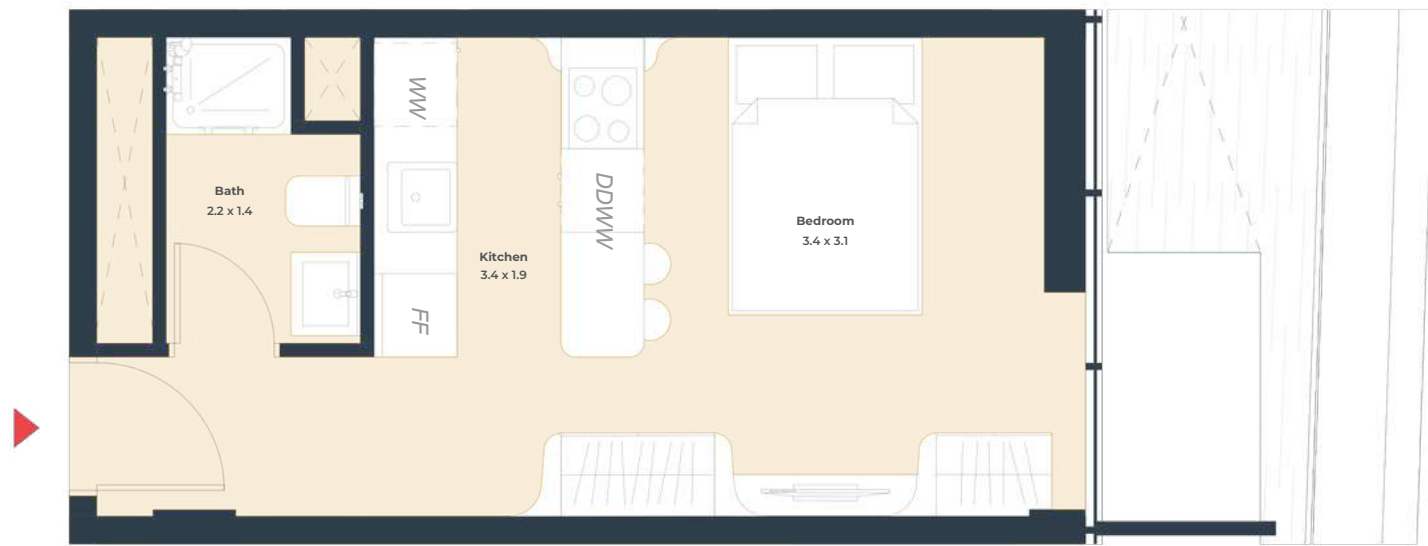

STUDIO A2

1F - 28th floor (Typical Floor)

Total Area	VARIES (29.63 sq.m - 42.13 sq.m)
Internal Area	27.23 sq.m
Balcony	VARIES (2.40 sq.m - 14.90 sq.m)

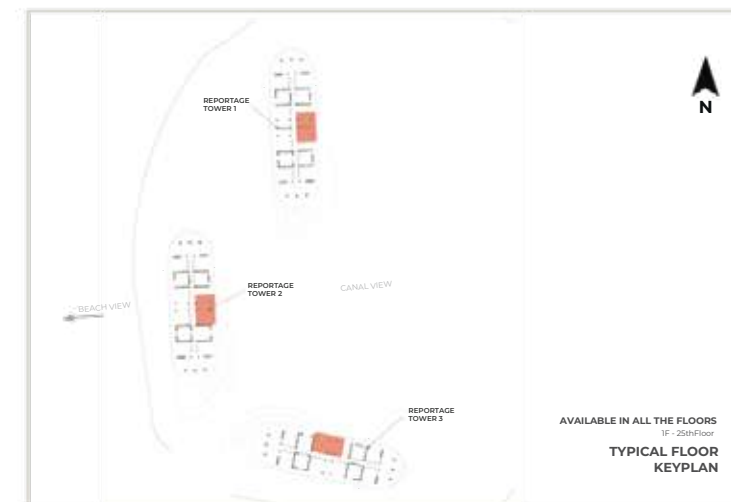

1BR - A

1F - 25th floor (Typical Floor)

Total Area	VARIES (58.79 sq.m - 83.75 sq.m)
Internal Area	54.45 sq.m
Balcony	VARIES (4.34 sq.m - 29.30 sq.m)

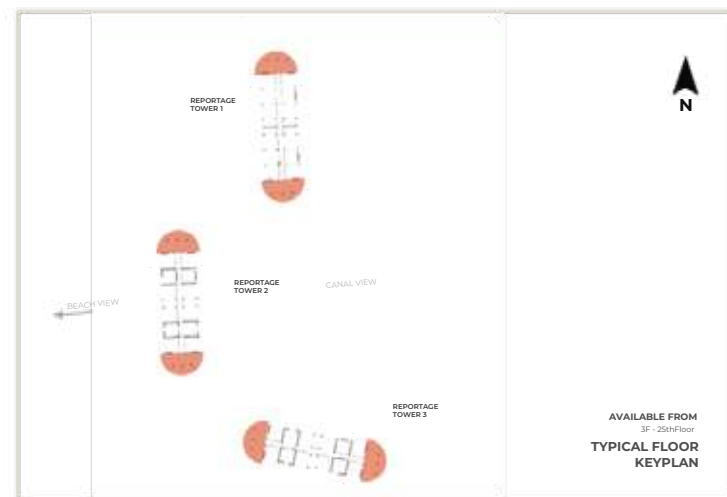

1BR - B

3F - 25th floor (Typical Floor)

Total Area	VARIES (64.52 sq.m - 111.99 sq.m)
Internal Area	55.12 sq.m
Balcony	VARIES (9.40 sq.m - 56.86 sq.m)

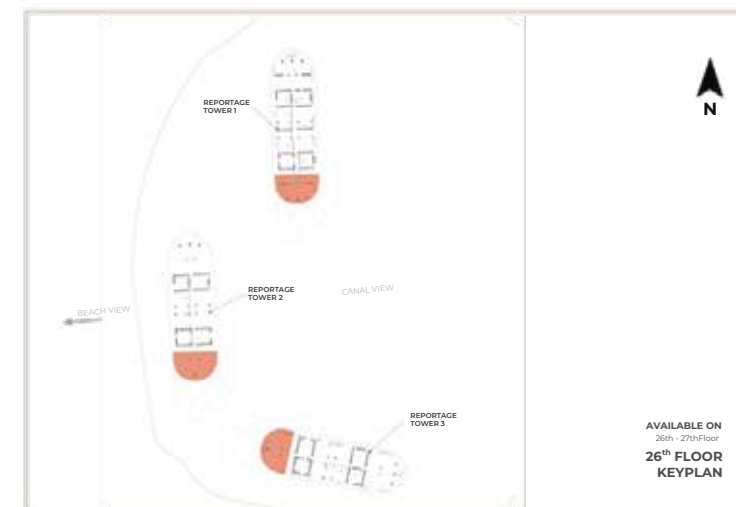

1BR - C

26th floor

Total Area	VARIES (89.22 sq.m - 91.37 sq.m)
Internal Area	55.12 sq.m
Balcony	VARIES (34.1 sq.m - 36.25 sq.m)

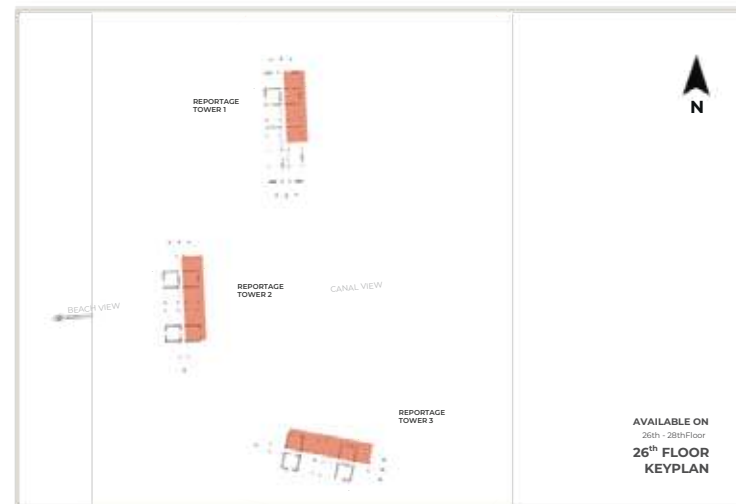

2BR - A1

26th floor (26th Floor)

Total Area	VARIABLES (85.70 sq.m - 86.20 sq.m)
Internal Area	VARIABLES (81.20 sq.m - 81.70 sq.m)
Balcony	4.5 sq.m

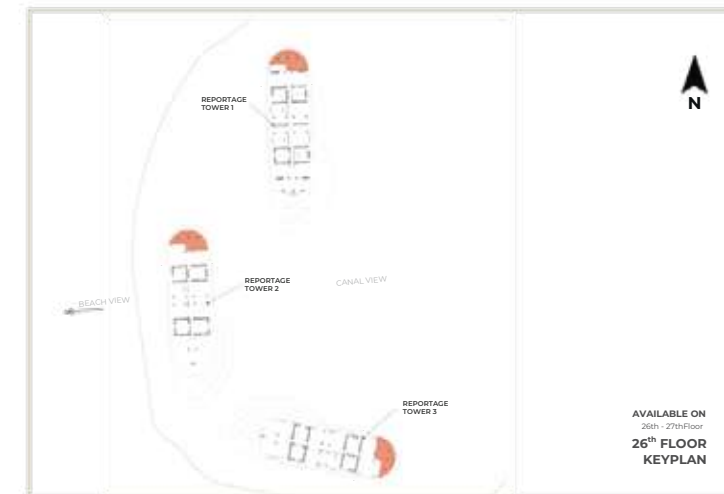

2BR+ - A

26th-27th floor (26th floor)

Total Area	102.30 sq.m
Internal Area	83.50 sq.m
Balcony	18.80 sq.m



2BR+ - A2

28th floor (28 Floor)

Total Area	150.30 sq.m
Internal Area	83.50 sq.m
Balcony	66.80 sq.m

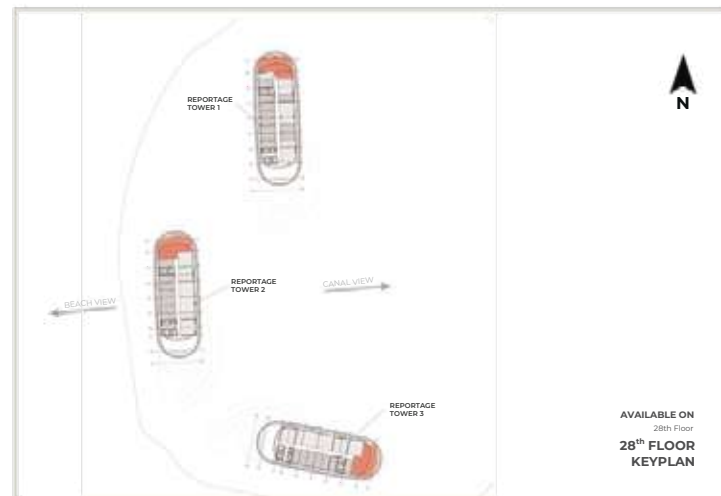

2BR+ - B

28th floor (28th floor)

Total Area	208.6 sq.m
Internal Area	107.8 sq.m
Balcony	100.77 sq.m

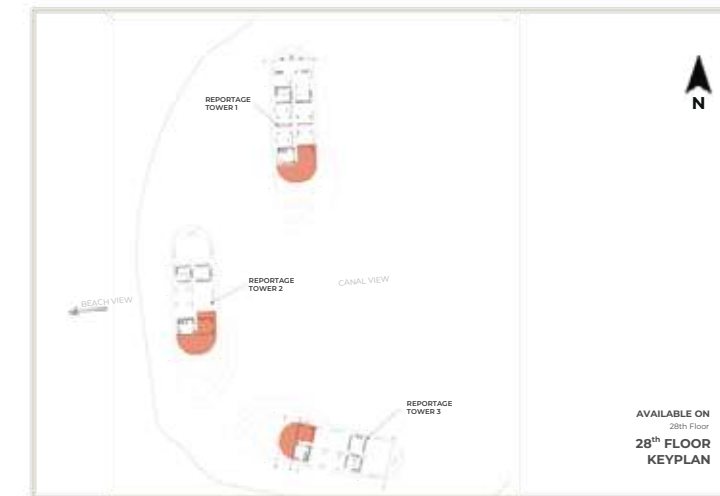



Reportage.

Abu Dhabi-UAE | Head Office

Tamouh Tower
28th Floor, Al Reem Island
P.O. Box: 111949
Tollfree: +971 800 77 55 2
info@reportageuae.com

Baku, Azerbaijan

Azerbaijan, Baku City,
Uzeyir Hajibəyov 33 street
+994 10 236 40 46
Info@reportageaz.com

Dubai- UAE

Anantara Business Tower
3rd Floor, Business Bay
P.O. Box: 27446
Tollfree: +971 800 77 55 2
info@reportageuae.com

Cairo - Eg ypt

Building 217
North Teseen St.
New Cairo
T: +20 12 0008 1190
info@reportageeg.com

Istanbul-Türkiye

Maslak Mh. Sümer Sk.
No:4, İç Kapı No:3, Bodrum Kat,
Maslak Office Building (MOB) Sarıyer
T: +90 530 774 9595
info@reportage.com.tr

Riyadh-KSA

Building No. 3230
Al Aflaj St., Al Suwaidi
P.O. Box 12791
T: +966 11 215 1110
info@reportageuae.com

Moscow-Russia

Yefremova Street 10s1, k4/4
bld sadovye kvartaly
P.O. Box 119048
info@reportagerussia.com

Kampala, Uganda

Plot 4, Philip Road
Near German Embassy
Kololo, Kampala, Uganda
+256 756 111 434 | +256 763 331 572
info@reportageug.com

Lahore - Pakistan

Plaza No. 185, Broadway
Commercial phase 8, DHA Lahore
+923309991111
Info@reportageempire.com

Kigali, Rwanda

KG 334 ST 10, Nyarutarama,
Kigali, Rwanda
+250738532168 | +250794100607
info@reportagerw.com

Nairobi, Kenya

46 Kabasiran, Lavington
P.O. box 38802-00623
Tel. +254 754 108108 / +254 208
108108

Lagos, Nigeria

No. 2 Obudu Close, Osborne
Foreshore Estate, Phase 1, Ikoyi, Lagos
Nigeria
+234 810 859 9924
Info@reportage.ng

**For more information, visit reportageuae.com
or call 800 77 55 2 | +971 50 244 1078**



Legal Disclaimer:

The information contained in this brochure is confidential and is for the exclusive use of the recipient. This brochure may not be reproduced, distributed, delivered, or furnished to any person without the prior written approval of Reportage Properties. No representation or warranty (expressed or implied) is made or can be given with respect to the accuracy or completeness of the information herein, or that any future offer of units or apartments in the project will conform to the terms described herein. Nothing in this leaflet should be constructed as financial, legal, tax or regulatory advice. All accessories such as electronics, furniture, white goods, decorative elements and so forth included in this brochure are not part of the standard unit and used for illustration purposes only. All plans, layouts, pictures, renderings, information and details included in this brochure are indicative only and may change at any time up to the final 'as built' status in accordance with final designs of the project and regulatory approvals and planning permissions.



